

Appendix C

City of Lincoln sites

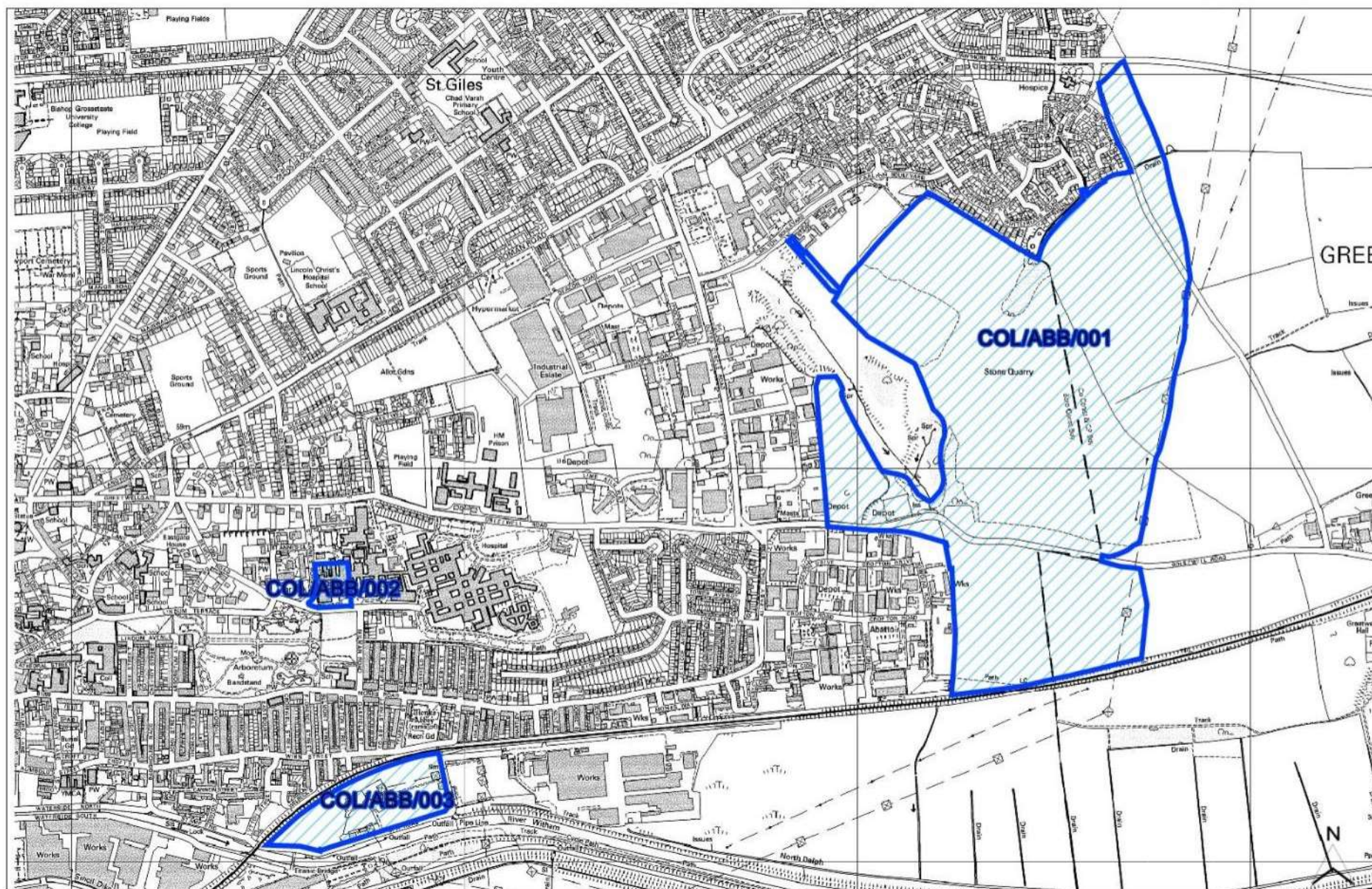

Site Reference	COL/ABB/001		
Old Reference (if applicable)	CL818		
Site Address	North East Quadrant, Land at Greetwell area, Lincoln		
Parish	Greetwell		
Ward	Abbey; Nettleham	Easting	500431.2921
District	City of Lincoln; West Lindsey	Northing	372146.88211
Settlement Hierarchy	Lincoln Urban Area		
Current Use?	Agricultural and former minerals working		
Brownfield/ Greenfield?	Mixed		
Site Area (ha):	82.94	Potential Capacity: 1991	

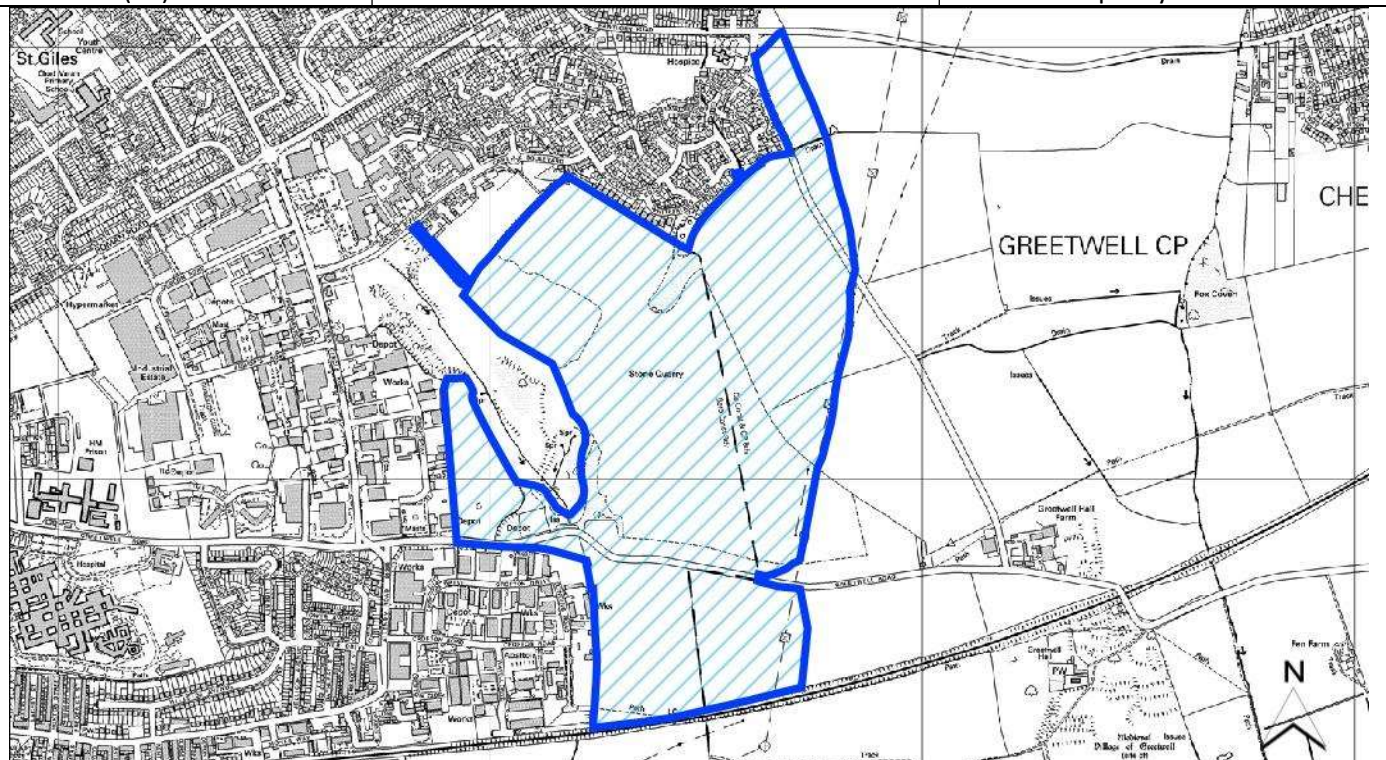

Constraint Check

Some or all of site in Flood Risk Zone 2	No	Surface Water Flooding – > 50% of site at High Risk	No	Within consultation zone of Hazardous Site or Pipeline	No
Nationally Important Wildlife Site	Yes	Locally Important Wildlife Site	Yes	Ancient Woodland	No
Tree Preservation Order	No	Protected Local Green Space	No	Area of Great Landscape Value	No
Agri Land Class – More than 50% of site Grade 1, 2 or 3	No	Green Wedge	Adjacent	Scheduled Ancient Monument	No
Historic Park and Garden	No	Area of Outstanding Natural Beauty	No		
Listed Building	No	Conservation Area	No		

Availability Check: When is the site available?

What use is the site promoted for?

0 – 5 Years	Yes	Housing	Yes
6 – 10 Years	No	Office	No
11 – 15 Years	No	Industrial/ Warehouse	Yes
16+ Years	No	Retail	No

Achievability Check

Viability assessment completed?	Yes	Gypsy/ Traveller Site	No
		Mixed Use	Yes
If yes, does it confirm site is viable?	Yes	Other Use	No

Site Reference	COL/ABB/002		
Old Reference (if applicable)	CL526		
Site Address	Former Main Hospital Complex, St Anne's Road, Lincoln		
Parish			
Ward	Abbey	Easting	498661.16206
District	City of Lincoln	Northing	371699.93188
Settlement Hierarchy	Lincoln Urban Area		
Current Use?	Car parking		
Brownfield/ Greenfield?	Brownfield		
Site Area (ha):	0.98	Potential Capacity: 33	

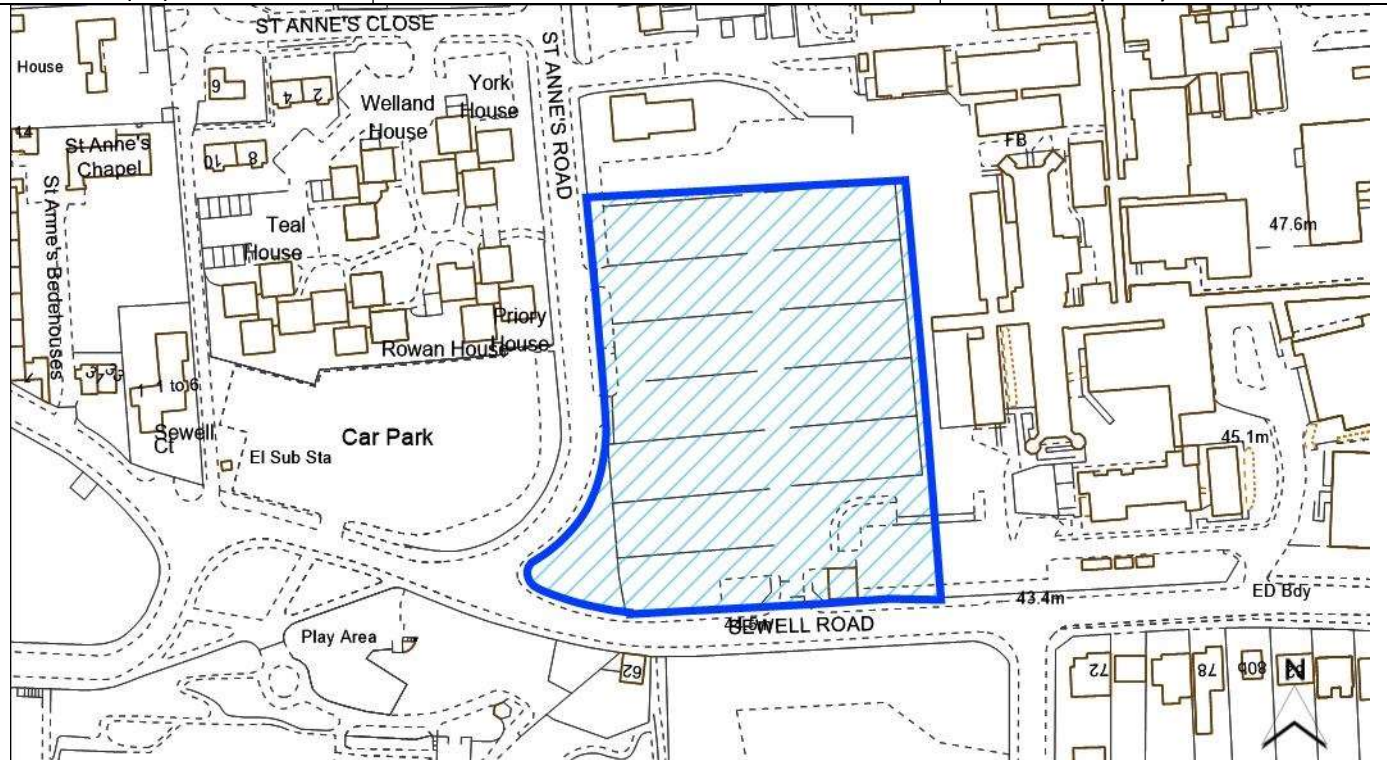

Constraint Check

Some or all of site in Flood Risk Zone 2	No	Surface Water Flooding – > 50% of site at High Risk	No	Within consultation zone of Hazardous Site or Pipeline	No
Nationally Important Wildlife Site	No	Locally Important Wildlife Site	No	Ancient Woodland	No
Tree Preservation Order	No	Protected Local Green Space	No	Area of Great Landscape Value	No
Agri Land Class – More than 50% of site Grade 1, 2 or 3	No	Green Wedge	No	Scheduled Ancient Monument	No
Historic Park and Garden	Within 200m	Area of Outstanding Natural Beauty	No		
Listed Building	Within 200m	Conservation Area	Within 200m		

Availability Check: When is the site available?

What use is the site promoted for?

0 – 5 Years	No	Housing	Yes
6 – 10 Years	Yes	Office	No
11 – 15 Years	No	Industrial/ Warehouse	No
16+ Years	No	Retail	No
Achievability Check		Gypsy/ Traveller Site	No
Viability assessment completed?	No	Mixed Use	No
If yes, does it confirm site is viable?		Other Use	No

Site Reference	COL/ABB/003		
Old Reference (if applicable)	CL525		
Site Address	Former Cegb Power Station, Spa Road, Lincoln, LN2 5TB		
Parish			
Ward	Abbey	Easting	498760.54054
District	City of Lincoln	Northing	371142.63068
Settlement Hierarchy	Lincoln Urban Area		
Current Use?	Derelict site		
Brownfield/ Greenfield?	Brownfield		
Site Area (ha):	5.71	Potential Capacity: 171	

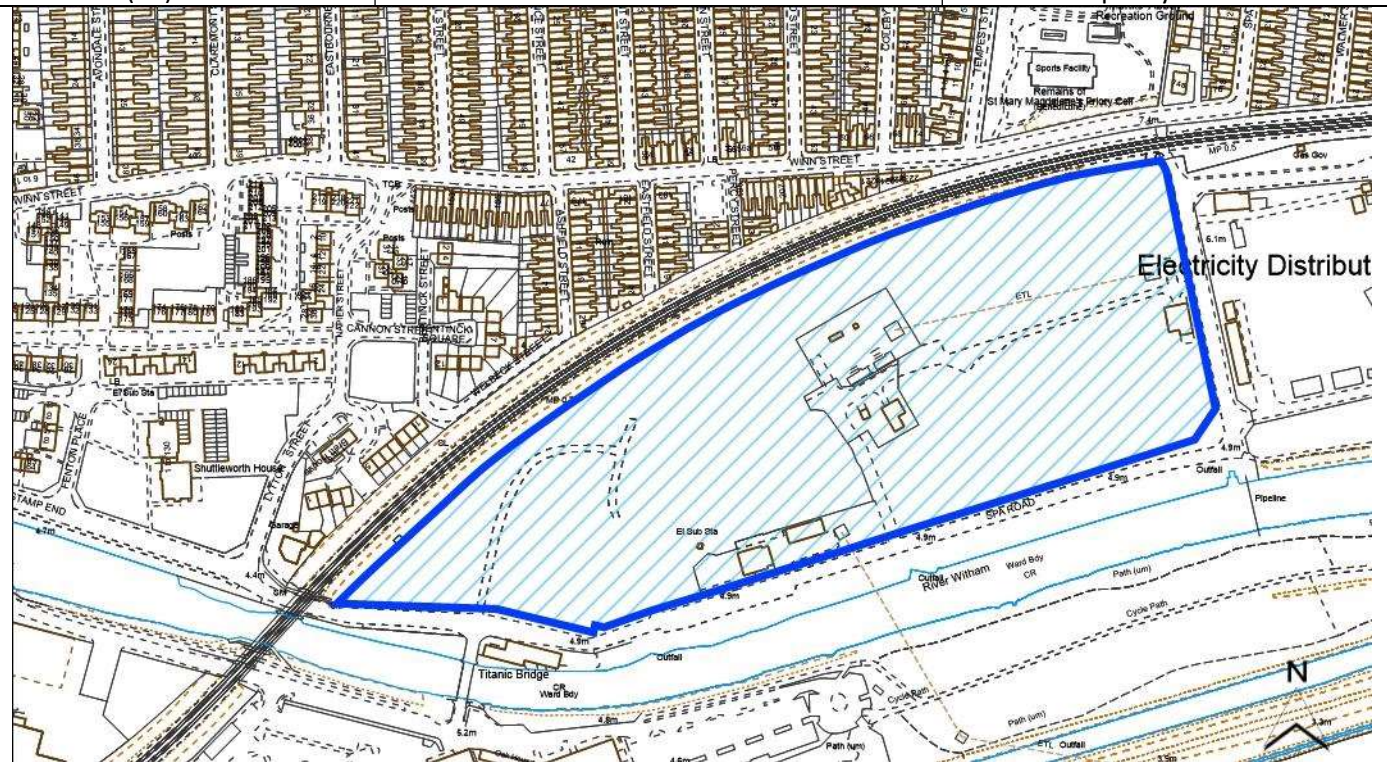

Constraint Check

Some or all of site in Flood Risk Zone 2	Yes	Surface Water Flooding – > 50% of site at High Risk	No	Within consultation zone of Hazardous Site or Pipeline	No
Nationally Important Wildlife Site	No	Locally Important Wildlife Site	Within 500m	Ancient Woodland	No
Tree Preservation Order	No	Protected Local Green Space	No	Area of Great Landscape Value	No
Agri Land Class – More than 50% of site Grade 1, 2 or 3	No	Green Wedge	Adjacent	Scheduled Ancient Monument	Within 200m
Historic Park and Garden	No	Area of Outstanding Natural Beauty	No		
Listed Building	Within 200m	Conservation Area	Within 200m		

Availability Check: When is the site available?

What use is the site promoted for?

0 – 5 Years	No	Housing	Yes
6 – 10 Years	Yes	Office	No
11 – 15 Years	No	Industrial/ Warehouse	No
16+ Years	No	Retail	No
Achievability Check		Gypsy/ Traveller Site	No
Viability assessment completed?	No	Mixed Use	No
If yes, does it confirm site is viable?		Other Use	No

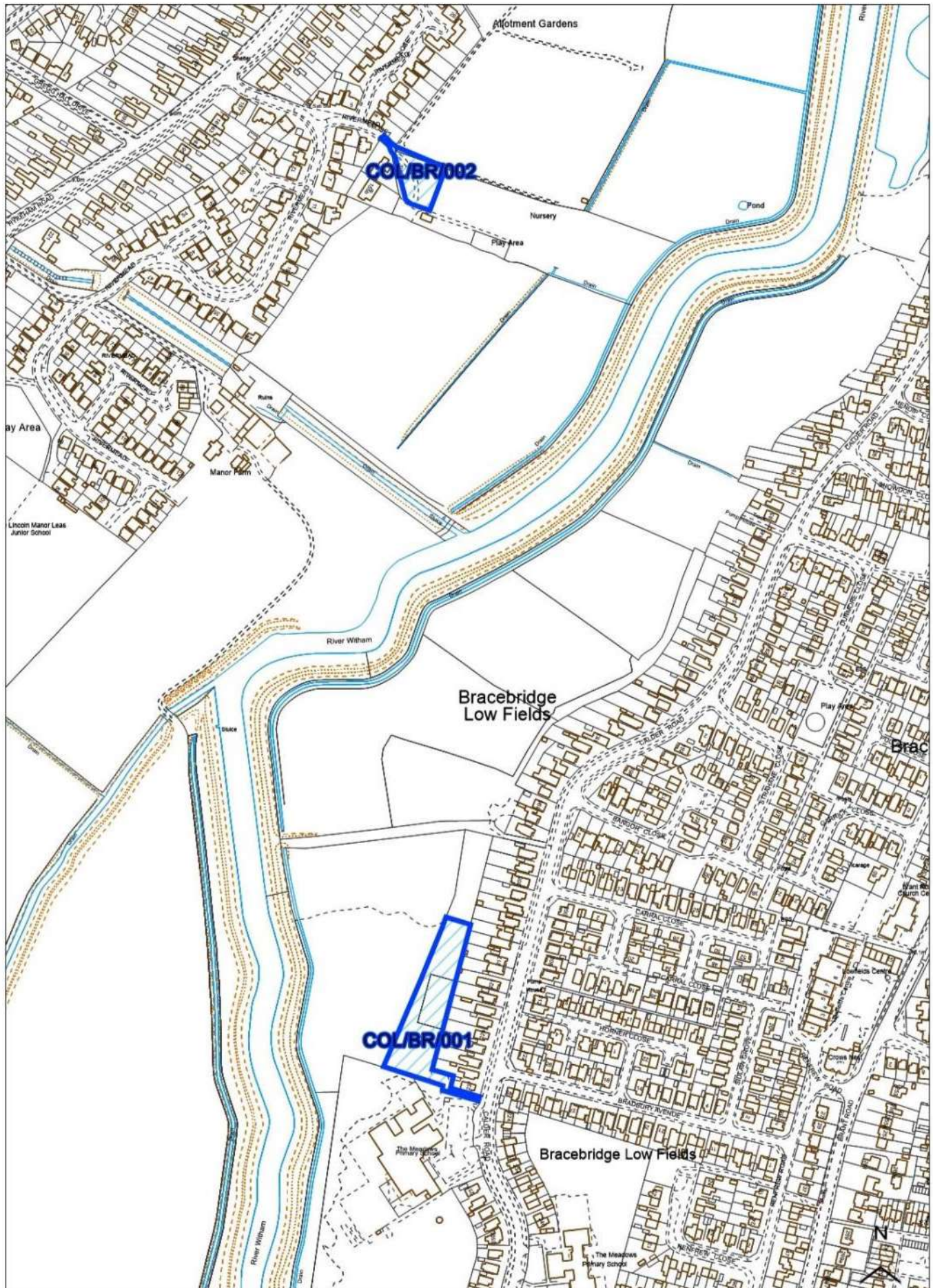

Site Reference	COL/BR/001		
Old Reference (if applicable)	CL826		
Site Address	Land rear of 2151-237 Calder Road, Lincoln		
Parish			
Ward	Bracebridge	Easting	496187.49062
District	City of Lincoln	Northing	366969.53177
Settlement Hierarchy	Lincoln Urban Area		
Current Use?	Riding School		
Brownfield/ Greenfield?	Mixed		
Site Area (ha):	0.43	Potential Capacity: 15	

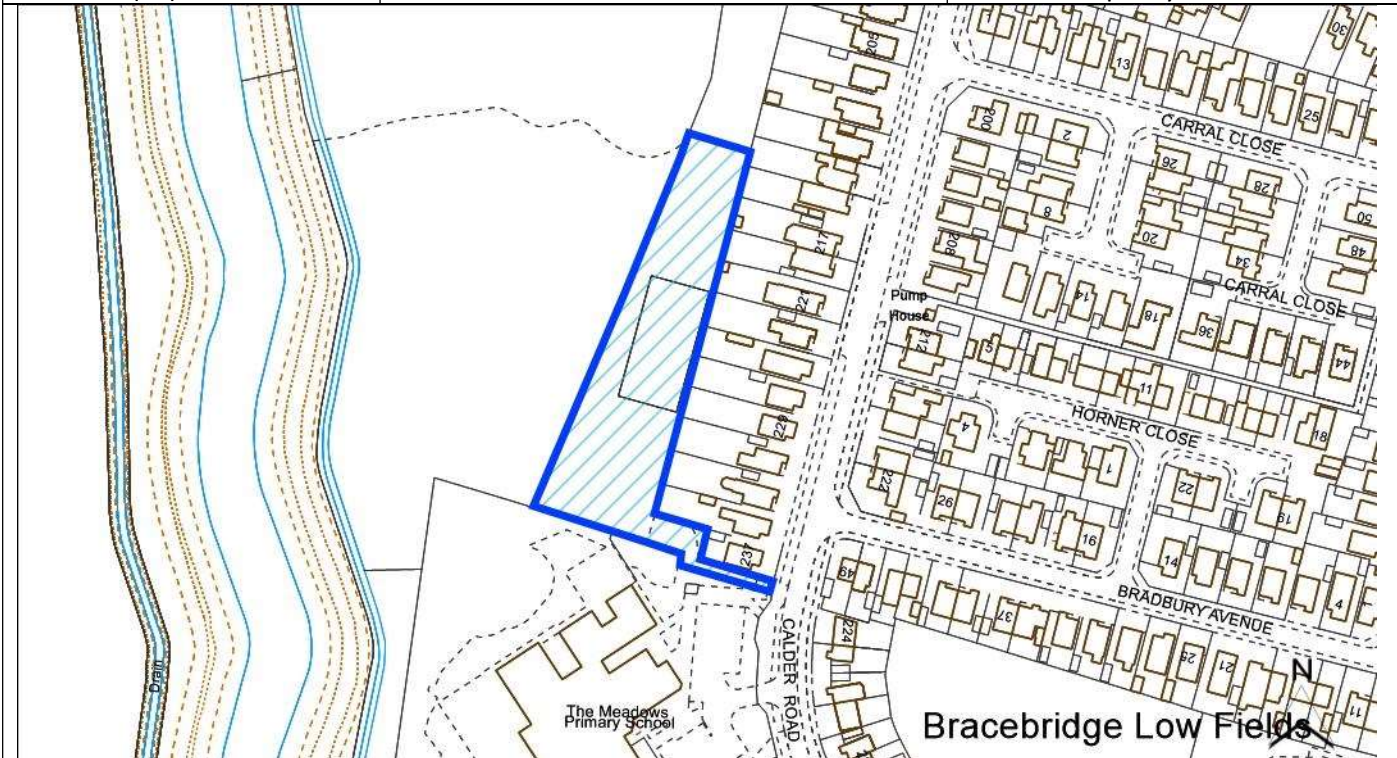

Constraint Check					
Some or all of site in Flood Risk Zone 2	Yes	Surface Water Flooding – > 50% of site at High Risk	No	Within consultation zone of Hazardous Site or Pipeline	No
Nationally Important Wildlife Site	No	Locally Important Wildlife Site	Within 500m	Ancient Woodland	No
Tree Preservation Order	No	Protected Local Green Space	No	Area of Great Landscape Value	No
Agri Land Class – More than 50% of site Grade 1, 2 or 3	No	Green Wedge	Yes	Scheduled Ancient Monument	No
Historic Park and Garden	No	Area of Outstanding Natural Beauty	No		
Listed Building	No	Conservation Area	No		
Availability Check: When is the site available?			What use is the site promoted for?		
0 – 5 Years	Yes		Housing	Yes	
6 – 10 Years	No		Office	No	
11 – 15 Years	No		Industrial/ Warehouse	No	
16+ Years	No		Retail	No	
Achievability Check			Gypsy/ Traveller Site	No	
Viability assessment completed?	Yes		Mixed Use	No	
If yes, does it confirm site is viable?	Yes		Other Use	No	

Site Reference	COL/BR/002		
Old Reference (if applicable)	CL531		
Site Address	Land at 6 Rivermead Close		
Parish			
Ward	Bracebridge	Easting	496176.20122
District	City of Lincoln	Northing	367656.02328
Settlement Hierarchy	Lincoln Urban Area		
Current Use?	Grass land and out buildings		
Brownfield/ Greenfield?	Mixed		
Site Area (ha):	0.14	Potential Capacity: 5	

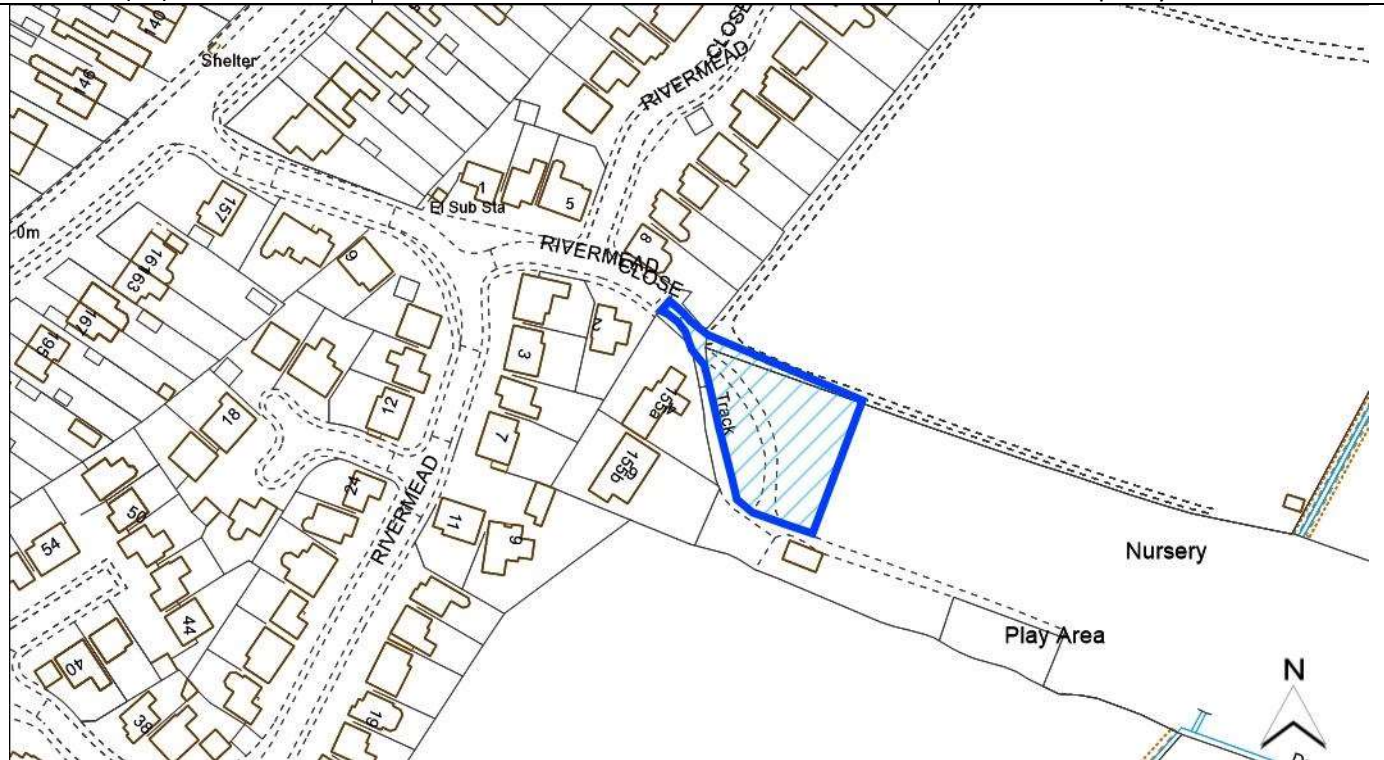

Constraint Check					
Some or all of site in Flood Risk Zone 2	No	Surface Water Flooding – > 50% of site at High Risk	No	Within consultation zone of Hazardous Site or Pipeline	No
Nationally Important Wildlife Site	No	Locally Important Wildlife Site	Within 500m	Ancient Woodland	No
Tree Preservation Order	No	Protected Local Green Space	No	Area of Great Landscape Value	No
Agri Land Class – More than 50% of site Grade 1, 2 or 3	No	Green Wedge	Yes	Scheduled Ancient Monument	No
Historic Park and Garden	No	Area of Outstanding Natural Beauty	No		
Listed Building	No	Conservation Area	No		
Availability Check: When is the site available?			What use is the site promoted for?		
0 – 5 Years	Yes		Housing	Yes	
6 – 10 Years	No		Office	No	
11 – 15 Years	No		Industrial/ Warehouse	No	
16+ Years	No		Retail	No	
Achievability Check			Gypsy/ Traveller Site	No	
Viability assessment completed?	No		Mixed Use	No	
If yes, does it confirm site is viable?			Other Use	No	

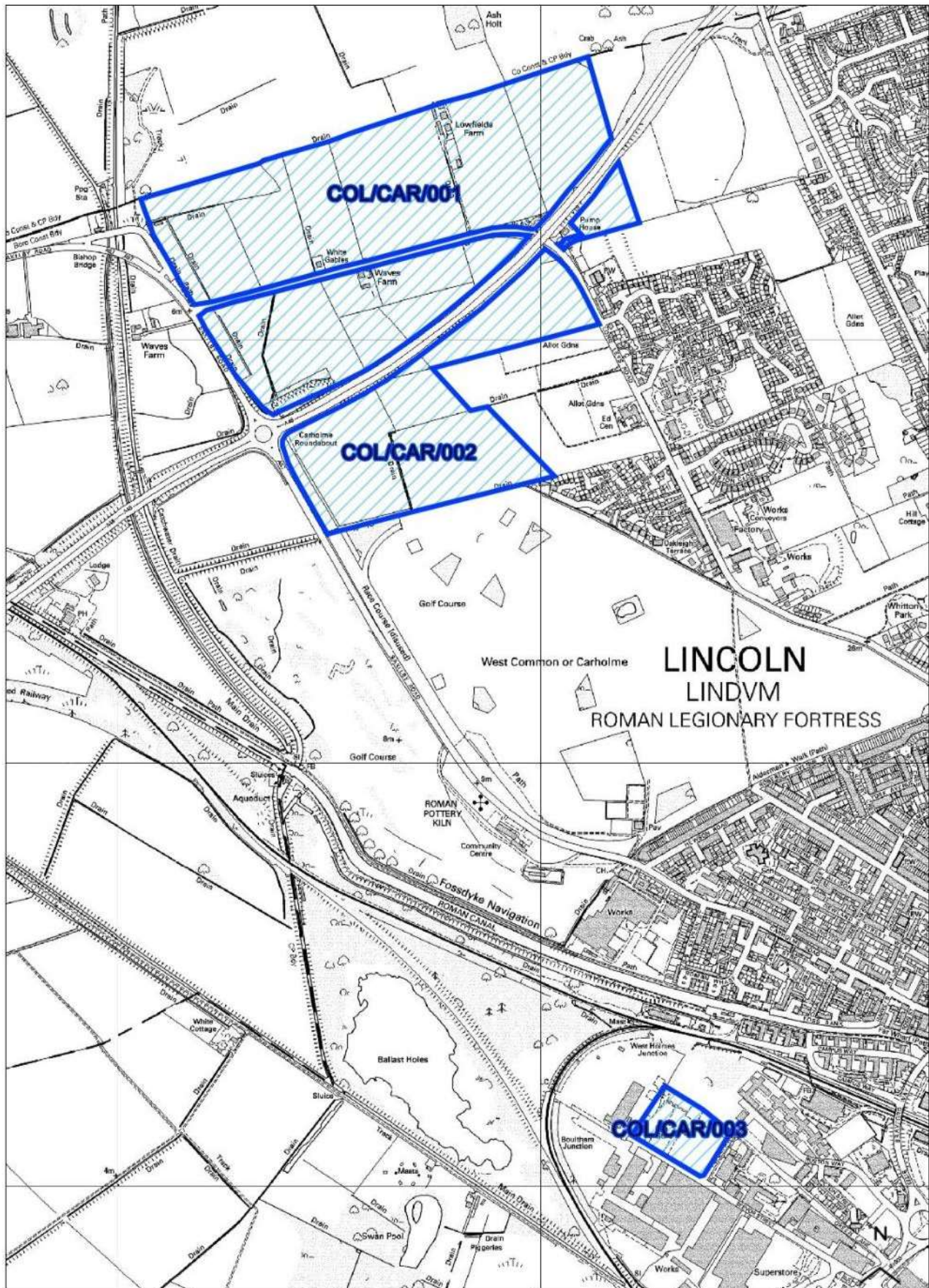

Site Reference	COL/CAR/002		
Old Reference (if applicable)	CL817		
Site Address	Farmland South of Long Leys Road		
Parish			
Ward	Carholme	Easting	495773.49869
District	City of Lincoln	Northing	372852.43632
Settlement Hierarchy	Lincoln Urban Area		
Current Use?	Agricultural		
Brownfield/ Greenfield?	Greenfield		
Site Area (ha):	21.11	Potential Capacity: 507	

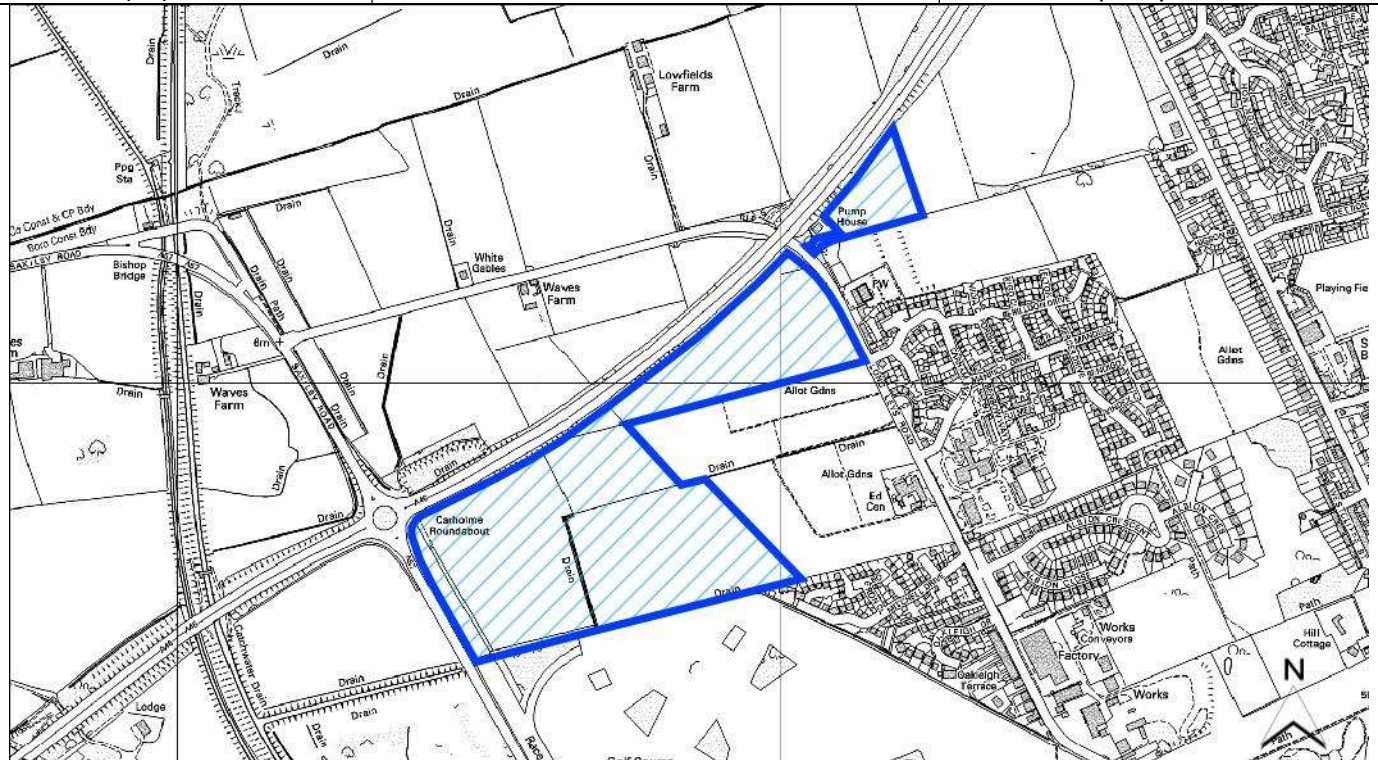

Constraint Check

Some or all of site in Flood Risk Zone 2	Yes	Surface Water Flooding – > 50% of site at High Risk	No	Within consultation zone of Hazardous Site or Pipeline	No
Nationally Important Wildlife Site	No	Locally Important Wildlife Site	Within 500m	Ancient Woodland	No
Tree Preservation Order	No	Protected Local Green Space	No	Area of Great Landscape Value	No
Agri Land Class – More than 50% of site Grade 1, 2 or 3	No	Green Wedge	Yes	Scheduled Ancient Monument	No
Historic Park and Garden	No	Area of Outstanding Natural Beauty	No		
Listed Building	No	Conservation Area	No		

Availability Check: When is the site available?

What use is the site promoted for?

0 – 5 Years	Yes	Housing	Yes
6 – 10 Years	No	Office	No
11 – 15 Years	No	Industrial/ Warehouse	No
16+ Years	No	Retail	No

Achievability Check

Viability assessment completed?	No	Gypsy/ Traveller Site	No
		Mixed Use	No
If yes, does it confirm site is viable?		Other Use	No

Site Reference	COL/CAR/003		
Old Reference (if applicable)	CL4641		
Site Address	Former Perkins Diesel Factory, North East Beevor Street, Lincoln		
Parish			
Ward	Carholme	Easting	496332.133
District	City of Lincoln	Northing	371126.45961
Settlement Hierarchy	Lincoln Urban Area		
Current Use?	Temporary car park and waste land		
Brownfield/ Greenfield?	Brownfield		
Site Area (ha):	2.63	Potential Capacity: 79	

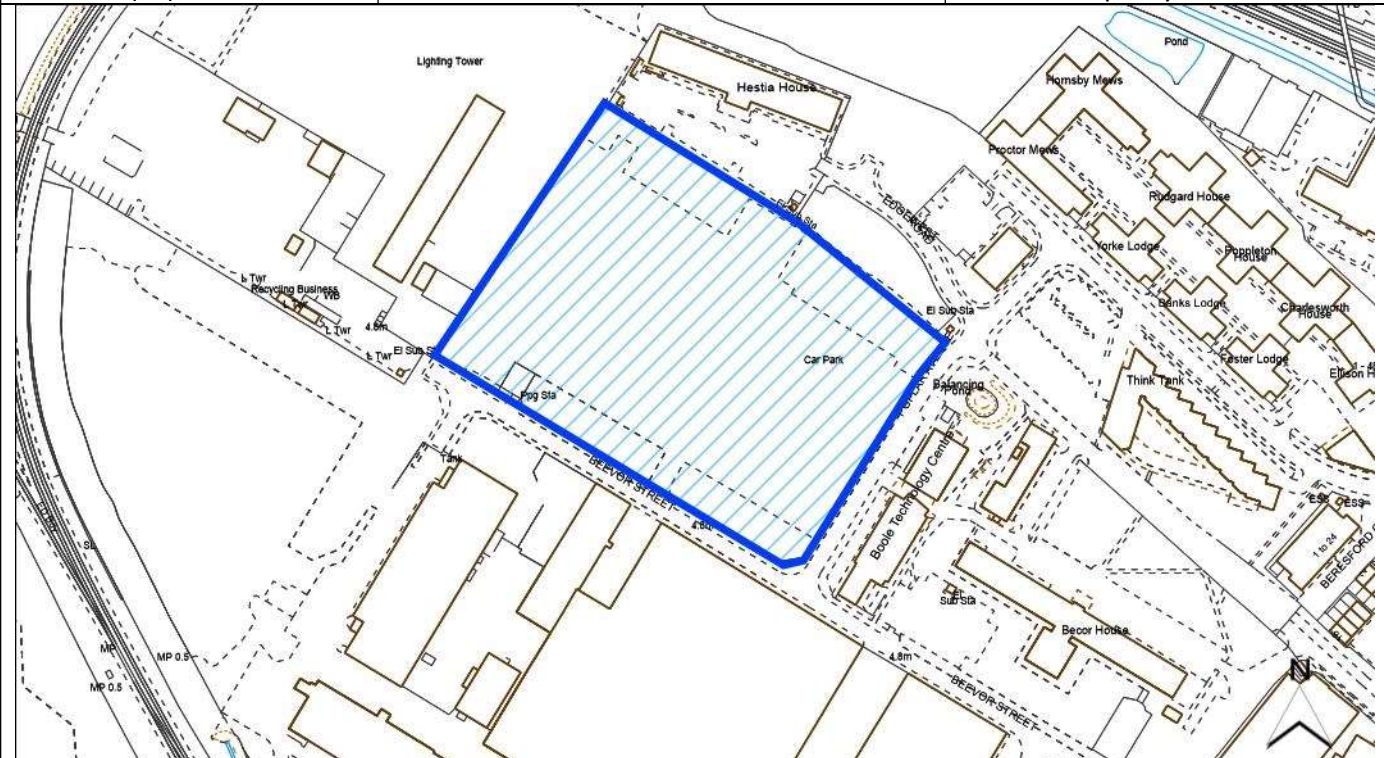

Constraint Check					
Some or all of site in Flood Risk Zone 2	Yes	Surface Water Flooding – > 50% of site at High Risk	No	Within consultation zone of Hazardous Site or Pipeline	No
Nationally Important Wildlife Site	No	Locally Important Wildlife Site	Within 500m	Ancient Woodland	No
Tree Preservation Order	No	Protected Local Green Space	No	Area of Great Landscape Value	No
Agri Land Class – More than 50% of site Grade 1, 2 or 3	No	Green Wedge	No	Scheduled Ancient Monument	No
Historic Park and Garden	No	Area of Outstanding Natural Beauty	No		
Listed Building	No	Conservation Area	No		
Availability Check: When is the site available?			What use is the site promoted for?		
0 – 5 Years	Yes		Housing	No	
6 – 10 Years	No		Office	Yes	
11 – 15 Years	No		Industrial/ Warehouse	Yes	
16+ Years	No		Retail	No	
Achievability Check			Gypsy/ Traveller Site	No	
Viability assessment completed?	Yes		Mixed Use	No	
If yes, does it confirm site is viable?	Yes		Other Use	No	

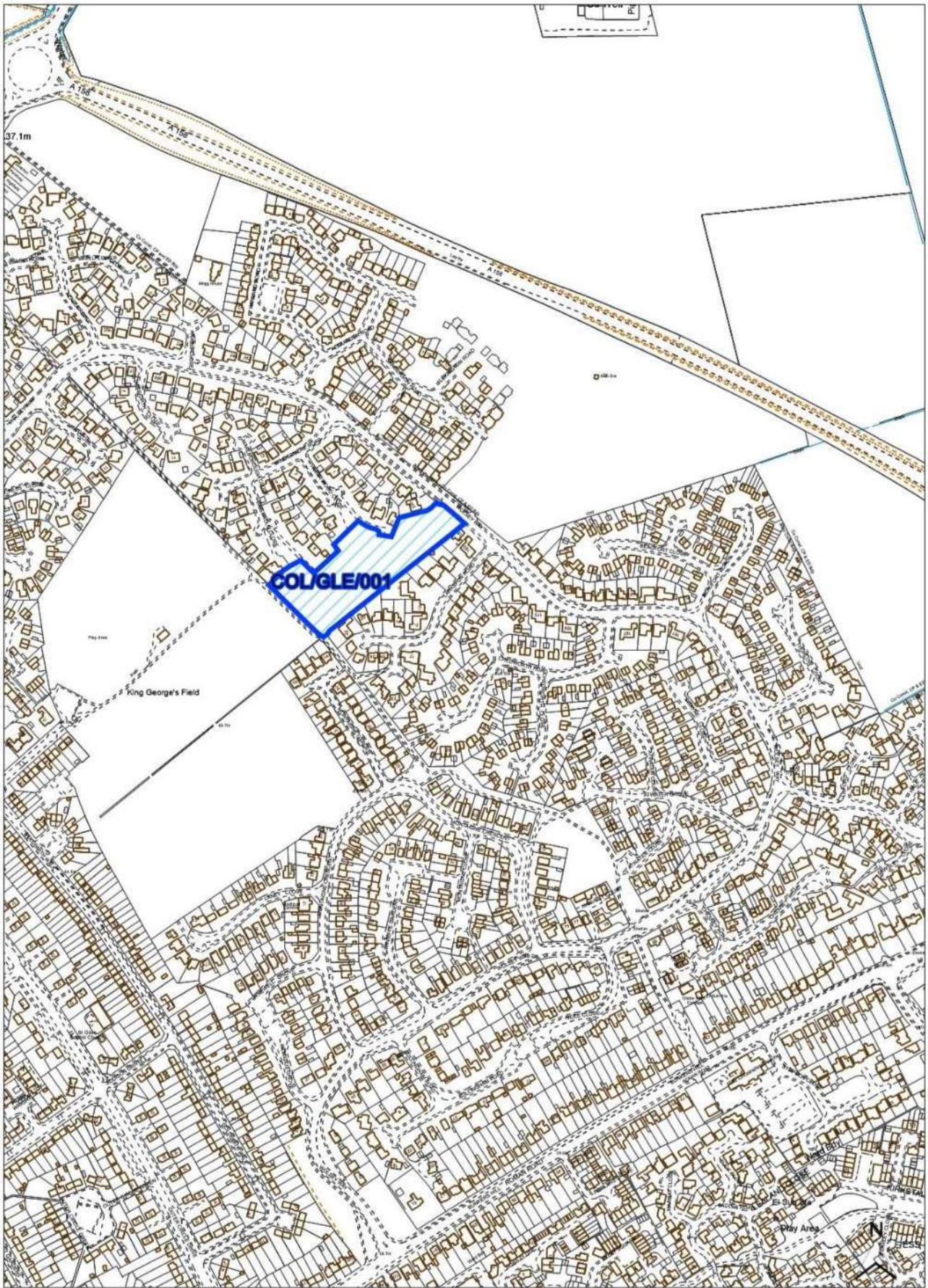

Site Reference	COL/GLE/001		
Old Reference (if applicable)	CL4432		
Site Address	Land off Wolsey Way, Lincoln		
Parish			
Ward	Glebe	Easting	499611.37546
District	City of Lincoln	Northing	373557.53849
Settlement Hierarchy	Lincoln Urban Area		
Current Use?	Open Space		
Brownfield/ Greenfield?	Greenfield		
Site Area (ha):	1.08	Potential Capacity: 37	

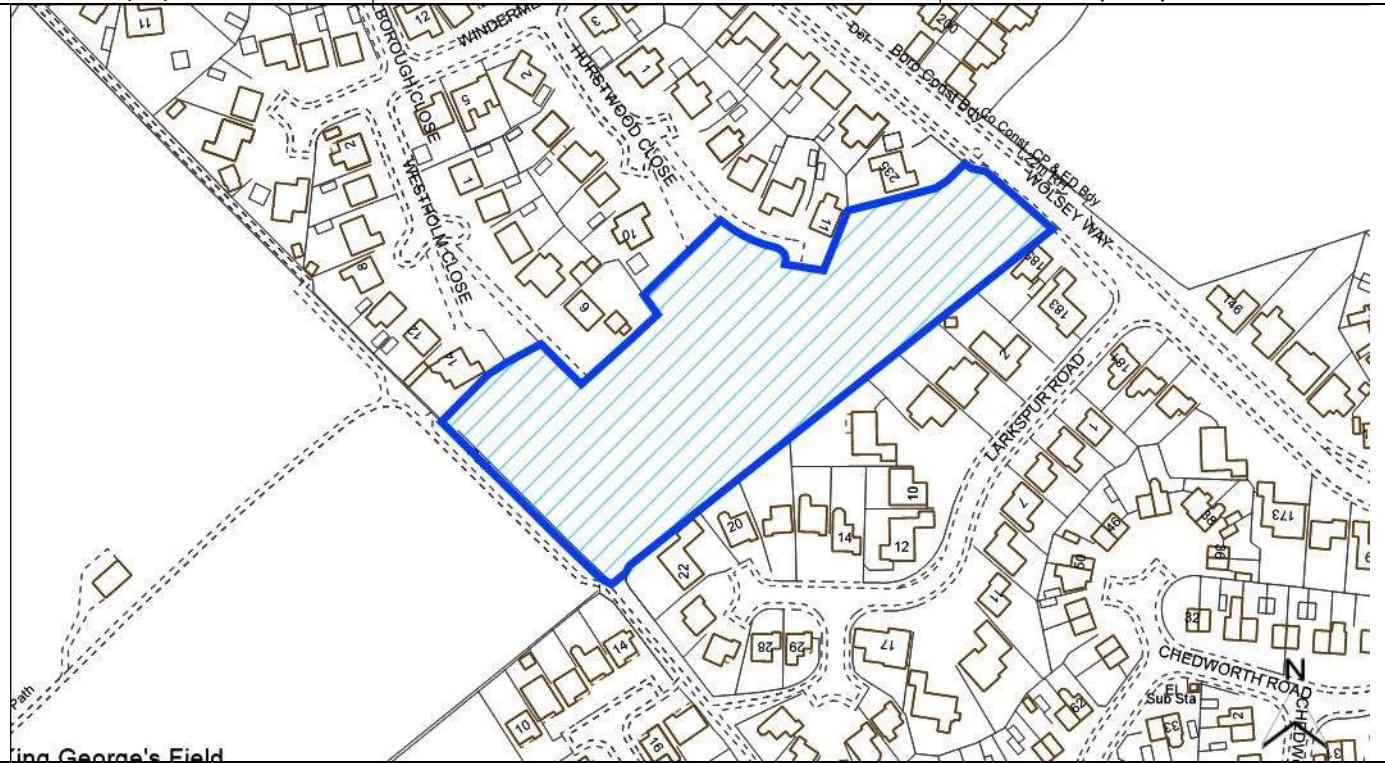

King George's Field

Constraint Check

Some or all of site in Flood Risk Zone 2	No	Surface Water Flooding – > 50% of site at High Risk	No	Within consultation zone of Hazardous Site or Pipeline	No
Nationally Important Wildlife Site	No	Locally Important Wildlife Site	No	Ancient Woodland	No
Tree Preservation Order	No	Protected Local Green Space	No	Area of Great Landscape Value	No
Agri Land Class – More than 50% of site Grade 1, 2 or 3	No	Green Wedge	No	Scheduled Ancient Monument	No
Historic Park and Garden	No	Area of Outstanding Natural Beauty	No		
Listed Building	No	Conservation Area	No		

Availability Check: When is the site available?

What use is the site promoted for?

0 – 5 Years	Yes	Housing	Yes
6 – 10 Years	No	Office	No
11 – 15 Years	No	Industrial/ Warehouse	No
16+ Years	No	Retail	No
Achievability Check		Gypsy/ Traveller Site	No
Viability assessment completed?	No	Mixed Use	No
If yes, does it confirm site is viable?		Other Use	No

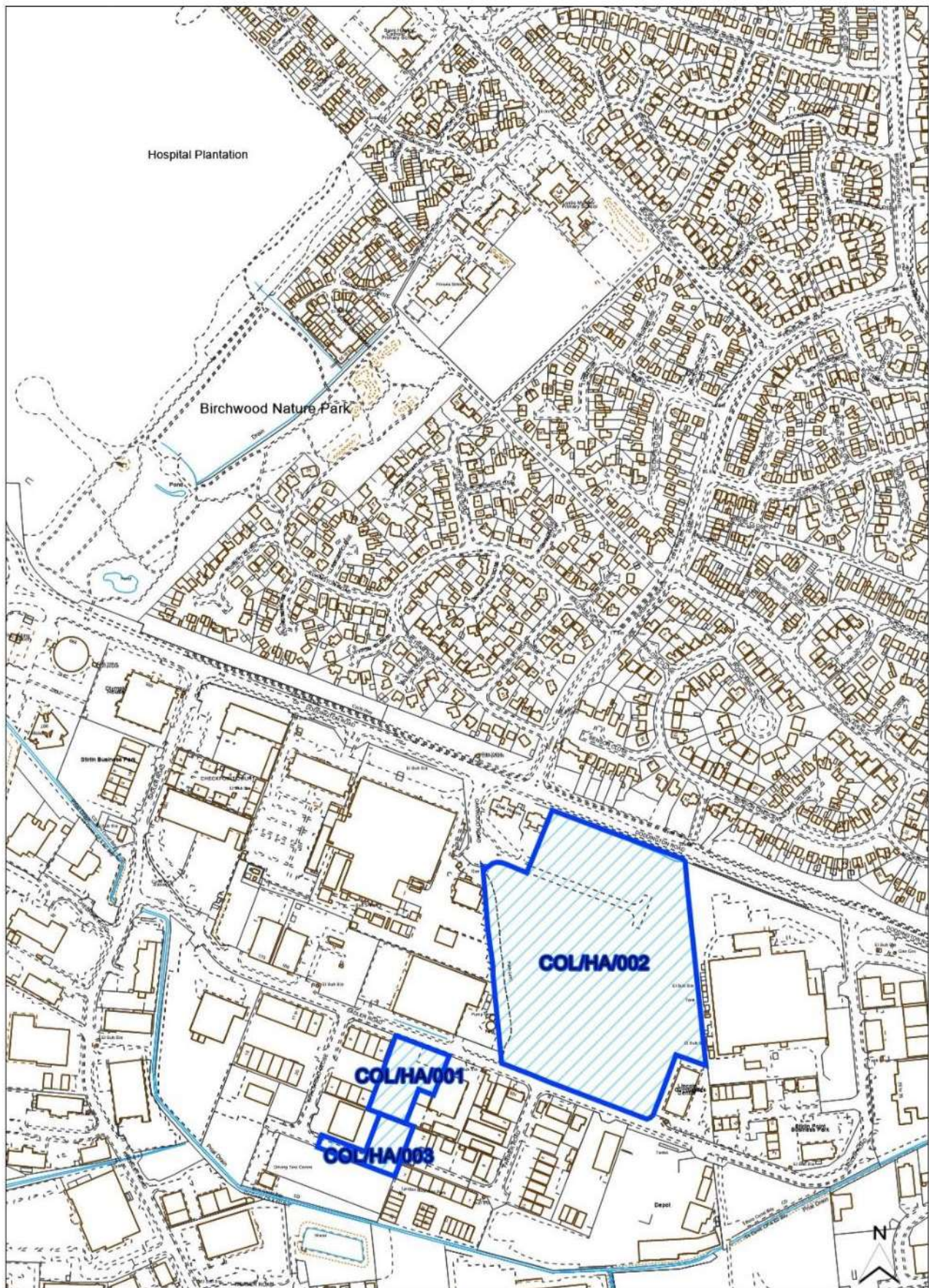

Site Reference	COL/HA/001		
Old Reference (if applicable)	CL4635		
Site Address	Land south of Sadler Road, Lincoln		
Parish			
Ward	Hartsholme	Easting	492864.03411
District	City of Lincoln	Northing	368299.49837
Settlement Hierarchy	Lincoln Urban Area		
Current Use?	Vacant		
Brownfield/ Greenfield?	Greenfield		
Site Area (ha):	0.41	Potential Capacity: 14	

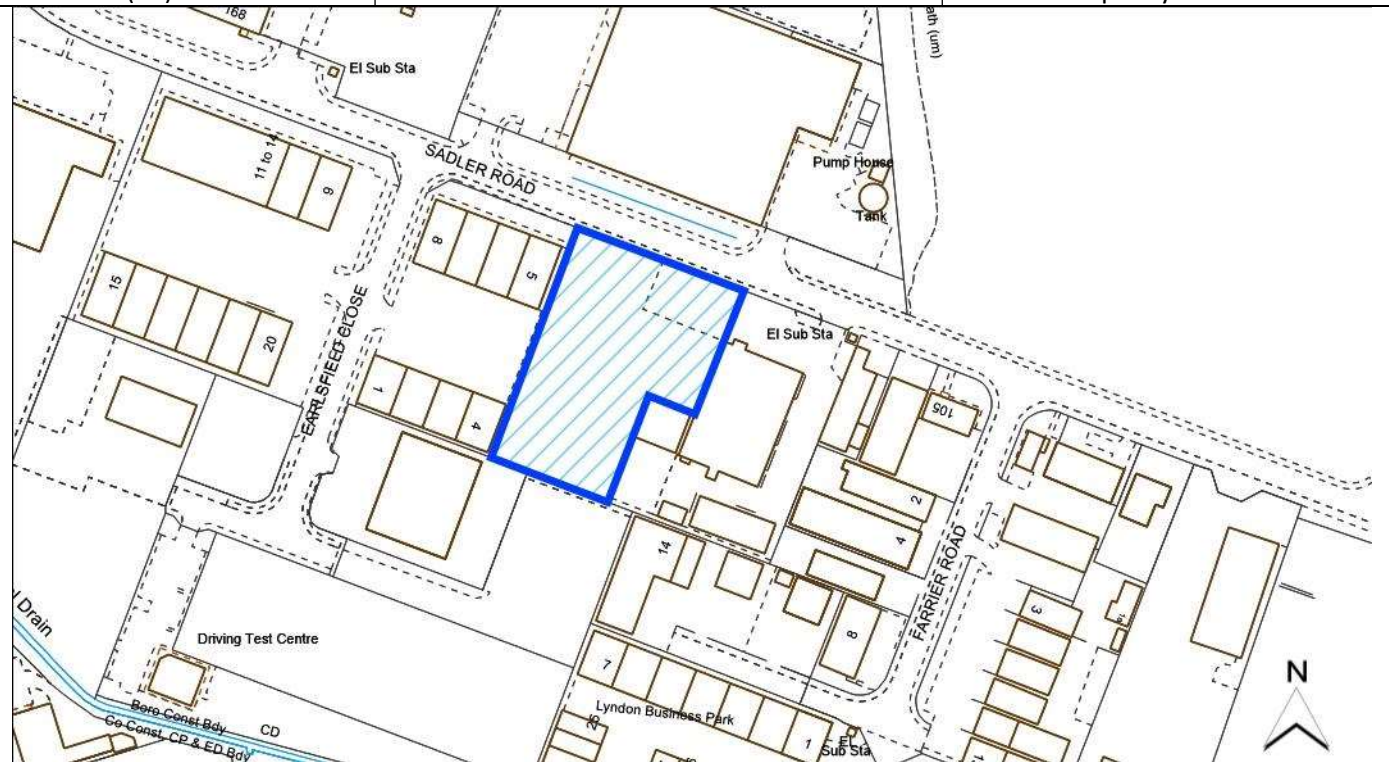

Constraint Check					
Some or all of site in Flood Risk Zone 2	No	Surface Water Flooding – > 50% of site at High Risk	No	Within consultation zone of Hazardous Site or Pipeline	No
Nationally Important Wildlife Site	No	Locally Important Wildlife Site	No	Ancient Woodland	No
Tree Preservation Order	No	Protected Local Green Space	No	Area of Great Landscape Value	No
Agri Land Class – More than 50% of site Grade 1, 2 or 3	No	Green Wedge	No	Scheduled Ancient Monument	No
Historic Park and Garden	No	Area of Outstanding Natural Beauty	No		
Listed Building	No	Conservation Area	No		
Availability Check: When is the site available?			What use is the site promoted for?		
0 – 5 Years	Yes		Housing	No	
6 – 10 Years	No		Office	No	
11 – 15 Years	No		Industrial/ Warehouse	Yes	
16+ Years	No		Retail	No	
Achievability Check			Gypsy/ Traveller Site	No	
Viability assessment completed?	No		Mixed Use	No	
If yes, does it confirm site is viable?			Other Use	No	

Site Reference	COL/HA/002		
Old Reference (if applicable)	CL4633		
Site Address	Land between Doddington Road and Sadler Road, Lincoln		
Parish			
Ward	Hartsholme	Easting	493057.80803
District	City of Lincoln	Northing	368415.96855
Settlement Hierarchy	Lincoln Urban Area		
Current Use?	Vacant		
Brownfield/ Greenfield?	Greenfield		
Site Area (ha):	5.27	Potential Capacity: 158	

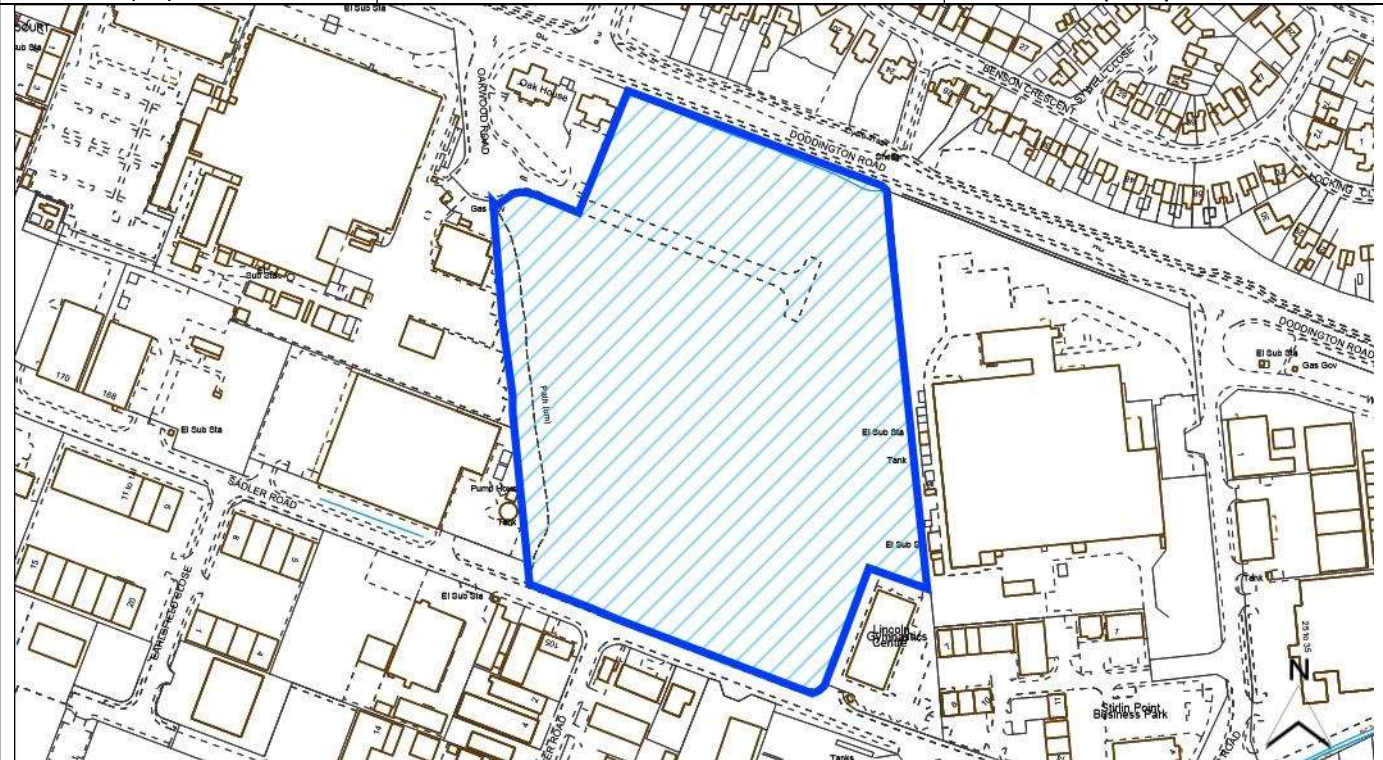

Constraint Check

Some or all of site in Flood Risk Zone 2	No	Surface Water Flooding – > 50% of site at High Risk	No	Within consultation zone of Hazardous Site or Pipeline	No
Nationally Important Wildlife Site	No	Locally Important Wildlife Site	Within 500m	Ancient Woodland	No
Tree Preservation Order	No	Protected Local Green Space	No	Area of Great Landscape Value	No
Agri Land Class – More than 50% of site Grade 1, 2 or 3	Yes	Green Wedge	No	Scheduled Ancient Monument	No
Historic Park and Garden	No	Area of Outstanding Natural Beauty	No		
Listed Building	No	Conservation Area	No		

Availability Check: When is the site available?

What use is the site promoted for?

0 – 5 Years	Yes	Housing	No
6 – 10 Years	No	Office	No
11 – 15 Years	No	Industrial/ Warehouse	Yes
16+ Years	No	Retail	No
Achievability Check		Gypsy/ Traveller Site	No
Viability assessment completed?	No	Mixed Use	No
If yes, does it confirm site is viable?		Other Use	No

Site Reference	COL/HA/003		
Old Reference (if applicable)	CL4628		
Site Address	Land east of Earlsfield Close, Lincoln		
Parish			
Ward	Hartsholme	Easting	492832.64771
District	City of Lincoln	Northing	368229.50026
Settlement Hierarchy	Lincoln Urban Area		
Current Use?	Vacant		
Brownfield/ Greenfield?	Brownfield		
Site Area (ha):	0.27	Potential Capacity: 11	

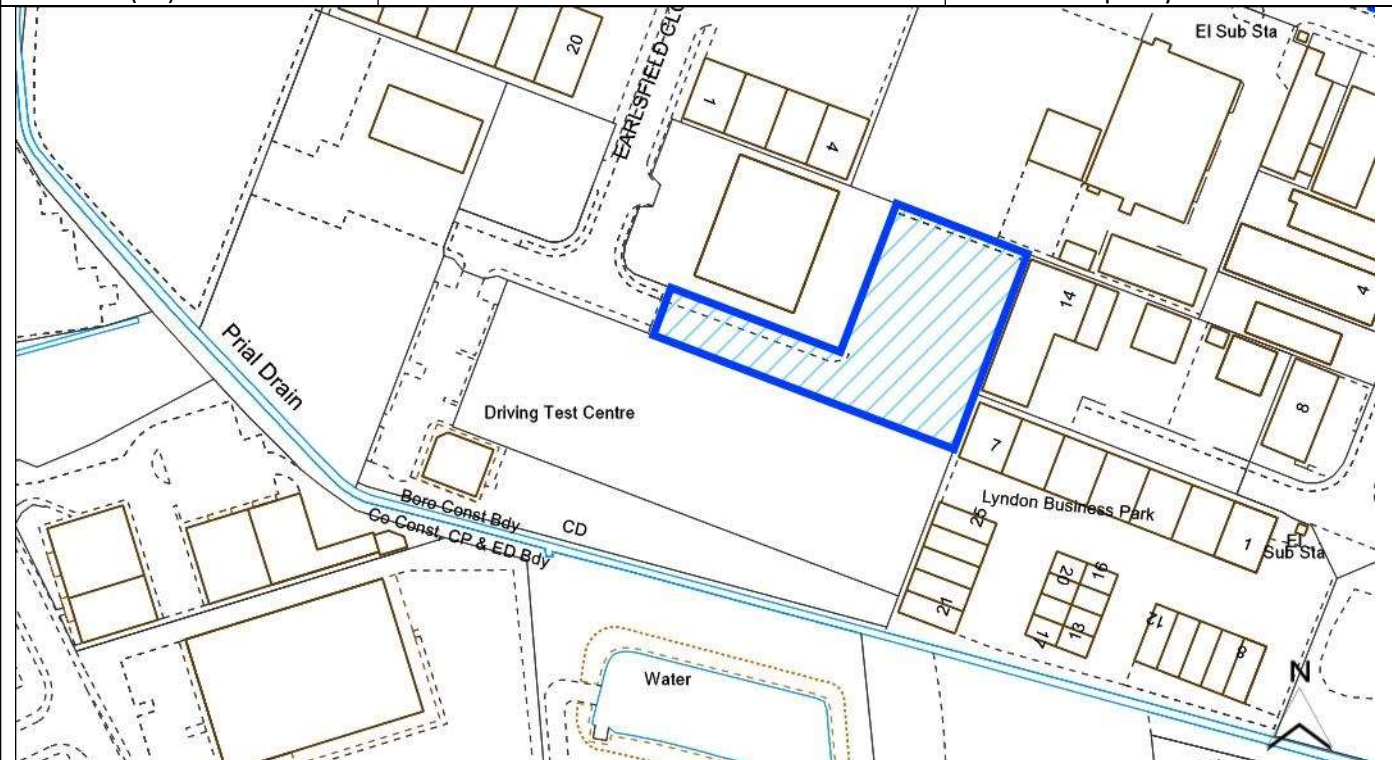

Constraint Check					
Some or all of site in Flood Risk Zone 2	No	Surface Water Flooding – > 50% of site at High Risk	No	Within consultation zone of Hazardous Site or Pipeline	No
Nationally Important Wildlife Site	No	Locally Important Wildlife Site	No	Ancient Woodland	No
Tree Preservation Order	No	Protected Local Green Space	No	Area of Great Landscape Value	No
Agri Land Class – More than 50% of site Grade 1, 2 or 3	Yes	Green Wedge	No	Scheduled Ancient Monument	No
Historic Park and Garden	No	Area of Outstanding Natural Beauty	No		
Listed Building	No	Conservation Area	No		
Availability Check: When is the site available?			What use is the site promoted for?		
0 – 5 Years	Yes		Housing	No	
6 – 10 Years	No		Office	No	
11 – 15 Years	No		Industrial/ Warehouse	Yes	
16+ Years	No		Retail	No	
Achievability Check			Gypsy/ Traveller Site	No	
Viability assessment completed?	No		Mixed Use	No	
If yes, does it confirm site is viable?			Other Use	No	

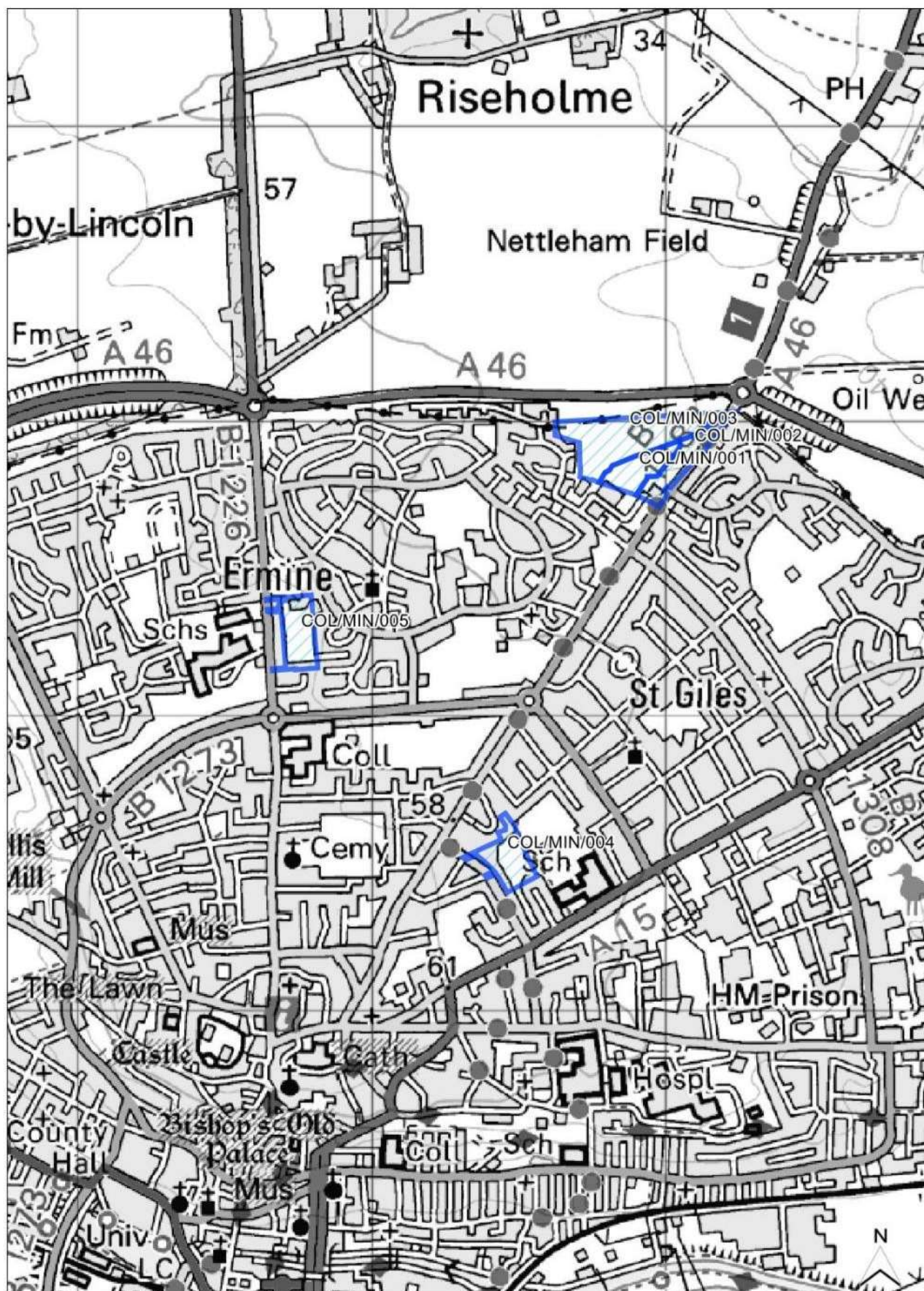

Site Reference	COL/MIN/001		
Old Reference (if applicable)	CL4430		
Site Address	Roman Gate 2, Land off Flavian Road, Lincoln		
Parish			
Ward	Minster	Easting	498905.28262
District	City of Lincoln	Northing	373831.57614
Settlement Hierarchy	Lincoln Urban Area		
Current Use?	Vacant		
Brownfield/ Greenfield?	Greenfield		
Site Area (ha):	2.17	Potential Capacity: 65	



Constraint Check

Some or all of site in Flood Risk Zone 2	No	Surface Water Flooding – > 50% of site at High Risk	No	Within consultation zone of Hazardous Site or Pipeline	No
Nationally Important Wildlife Site	No	Locally Important Wildlife Site	No	Ancient Woodland	No
Tree Preservation Order	No	Protected Local Green Space	No	Area of Great Landscape Value	No
Agri Land Class – More than 50% of site Grade 1, 2 or 3	No	Green Wedge	No	Scheduled Ancient Monument	No
Historic Park and Garden	No	Area of Outstanding Natural Beauty	No		
Listed Building	No	Conservation Area	No		

Availability Check: When is the site available?

What use is the site promoted for?

0 – 5 Years	Yes	Housing	Yes
6 – 10 Years	No	Office	No
11 – 15 Years	No	Industrial/ Warehouse	No
16+ Years	No	Retail	No

Achievability Check

Viability assessment completed?	No	Gypsy/ Traveller Site	No
If yes, does it confirm site is viable?		Mixed Use	No
		Other Use	No

Site Reference	COL/MIN/002		
Old Reference (if applicable)	CL4615		
Site Address	North West of Lincoln Road, Romangate, Lincoln		
Parish			
Ward	Minster	Easting	499042.88178
District	City of Lincoln	Northing	373851.11392
Settlement Hierarchy	Lincoln Urban Area		
Current Use?	Grass land		
Brownfield/ Greenfield?	Greenfield		
Site Area (ha):	2.41	Potential Capacity: 72	



Constraint Check

Some or all of site in Flood Risk Zone 2	No	Surface Water Flooding – > 50% of site at High Risk	No	Within consultation zone of Hazardous Site or Pipeline	No
Nationally Important Wildlife Site	No	Locally Important Wildlife Site	No	Ancient Woodland	No
Tree Preservation Order	No	Protected Local Green Space	No	Area of Great Landscape Value	No
Agri Land Class – More than 50% of site Grade 1, 2 or 3	No	Green Wedge	Adjacent	Scheduled Ancient Monument	No
Historic Park and Garden	No	Area of Outstanding Natural Beauty	No		
Listed Building	No	Conservation Area	No		

Availability Check: When is the site available?

What use is the site promoted for?

0 – 5 Years	Yes	Housing	No
6 – 10 Years	No	Office	No
11 – 15 Years	No	Industrial/ Warehouse	No
16+ Years	No	Retail	No
Achievability Check		Gypsy/ Traveller Site	No
Viability assessment completed?	No	Mixed Use	Yes
If yes, does it confirm site is viable?		Other Use	No

Site Reference	COL/MIN/003		
Old Reference (if applicable)	CL515		
Site Address	Romangate Development, land at Nettleham Road, Lincoln		
Parish			
Ward	Minster	Easting	498869.81916
District	City of Lincoln	Northing	373938.4765
Settlement Hierarchy	Lincoln Urban Area		
Current Use?	Residential under construction		
Brownfield/ Greenfield?	Greenfield		
Site Area (ha):	6.36	Potential Capacity: 191	

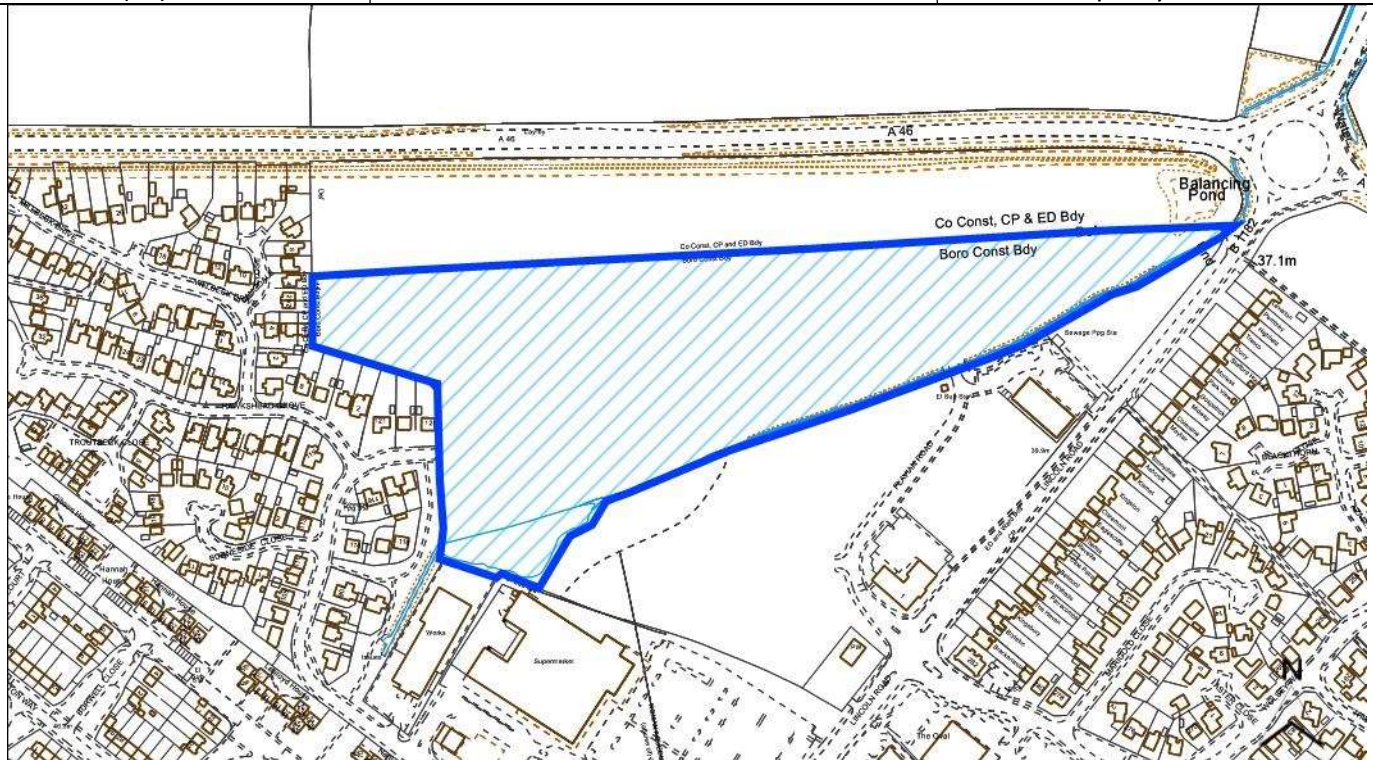

Constraint Check

Some or all of site in Flood Risk Zone 2	No	Surface Water Flooding – > 50% of site at High Risk	No	Within consultation zone of Hazardous Site or Pipeline	No
Nationally Important Wildlife Site	No	Locally Important Wildlife Site	No	Ancient Woodland	No
Tree Preservation Order	No	Protected Local Green Space	No	Area of Great Landscape Value	No
Agri Land Class – More than 50% of site Grade 1, 2 or 3	No	Green Wedge	Adjacent	Scheduled Ancient Monument	No
Historic Park and Garden	No	Area of Outstanding Natural Beauty	No		
Listed Building	No	Conservation Area	No		

Availability Check: When is the site available?

What use is the site promoted for?

0 – 5 Years	Yes	Housing	Yes
6 – 10 Years	No	Office	No
11 – 15 Years	No	Industrial/ Warehouse	No
16+ Years	No	Retail	No

Achievability Check

Viability assessment completed?	No	Gypsy/ Traveller Site	No
If yes, does it confirm site is viable?		Mixed Use	No
		Other Use	No

Site Reference	COL/MIN/004		
Old Reference (if applicable)	CL4431		
Site Address	Land off Lee Road, Lincoln		
Parish			
Ward	Minster	Easting	498457.31891
District	City of Lincoln	Northing	372509.42529
Settlement Hierarchy	Lincoln Urban Area		
Current Use?	Vacant		
Brownfield/ Greenfield?	Greenfield		
Site Area (ha):	2.56	Potential Capacity: 77	

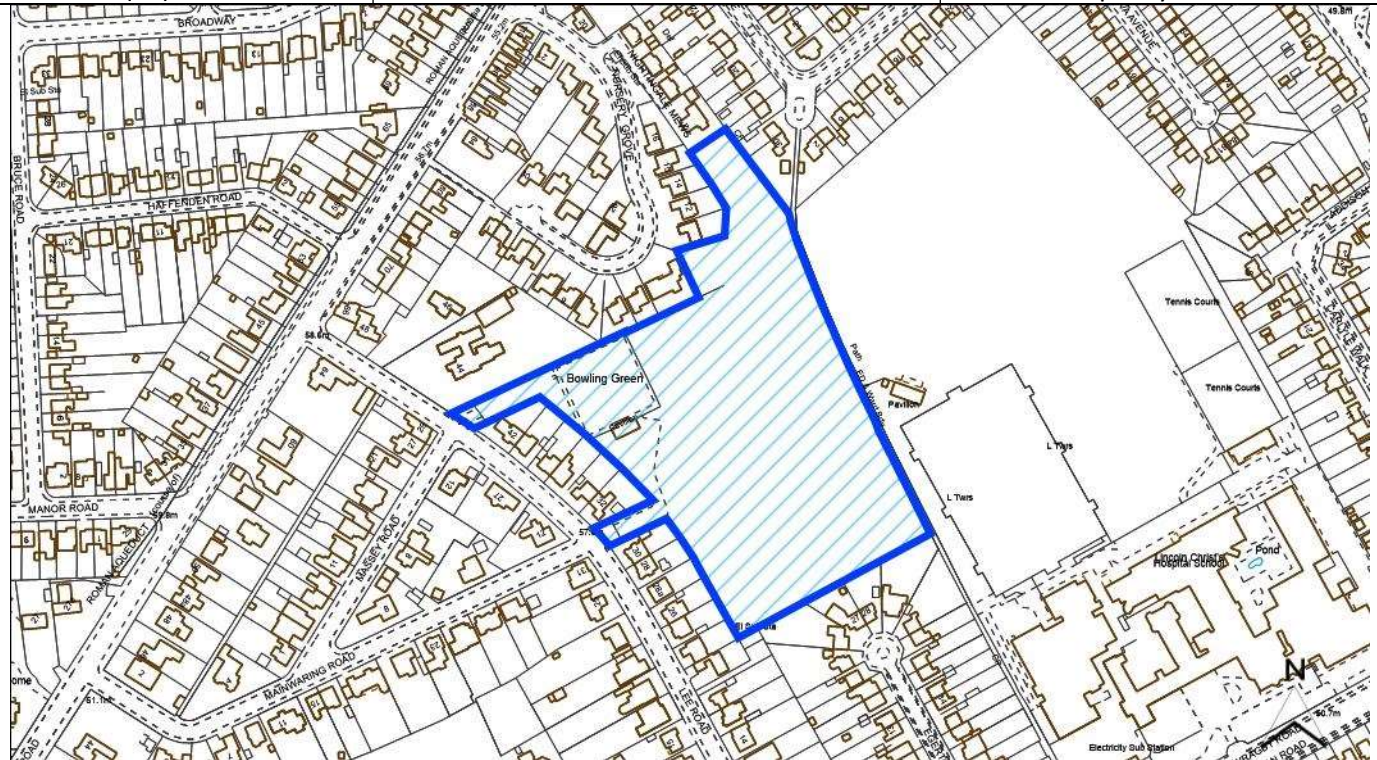

Constraint Check

Some or all of site in Flood Risk Zone 2	No	Surface Water Flooding – > 50% of site at High Risk	No	Within consultation zone of Hazardous Site or Pipeline	No
Nationally Important Wildlife Site	No	Locally Important Wildlife Site	No	Ancient Woodland	No
Tree Preservation Order	No	Protected Local Green Space	Part	Area of Great Landscape Value	No
Agri Land Class – More than 50% of site Grade 1, 2 or 3	No	Green Wedge	No	Scheduled Ancient Monument	No
Historic Park and Garden	No	Area of Outstanding Natural Beauty	No		
Listed Building	Within 200m	Conservation Area	No		

Availability Check: When is the site available?

What use is the site promoted for?

0 – 5 Years	Yes	Housing	Yes
6 – 10 Years	No	Office	No
11 – 15 Years	No	Industrial/ Warehouse	No
16+ Years	No	Retail	No
Achievability Check		Gypsy/ Traveller Site	No
Viability assessment completed?	No	Mixed Use	No
If yes, does it confirm site is viable?		Other Use	No

Site Reference	COL/MIN/005		
Old Reference (if applicable)			
Site Address	Land at Cathedral Quarry, Riseholme Road, Lincoln		
Parish			
Ward	Minster	Easting	
District	City of Lincoln	Northing	
Settlement Hierarchy	Lincoln Urban Area		
Current Use?	Former quarry		
Brownfield/ Greenfield?	Brownfield		
Site Area (ha):	2.74	Potential Capacity: 82	

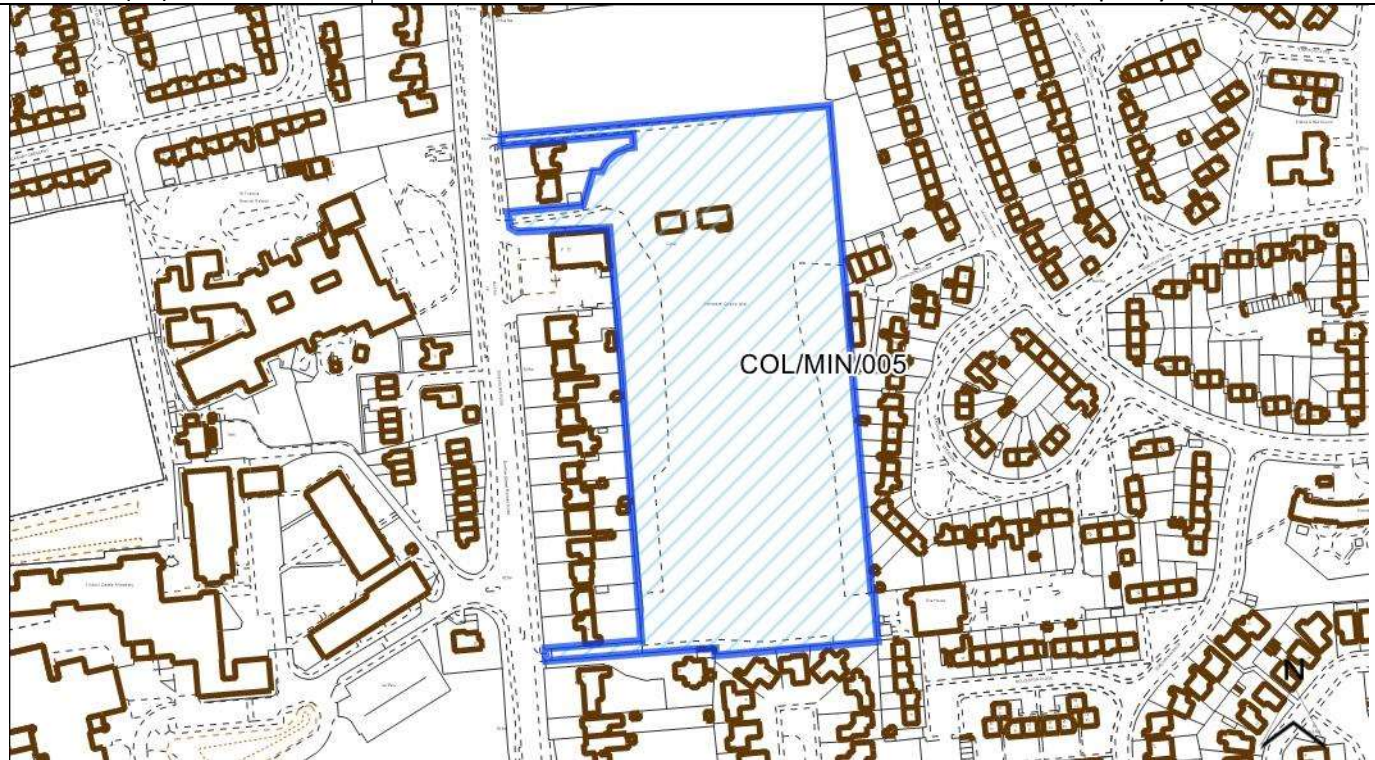

Constraint Check					
Some or all of site in Flood Risk Zone 2	no	Surface Water Flooding – > 50% of site at High Risk	no	Within consultation zone of Hazardous Site or Pipeline	no
Nationally Important Wildlife Site	no	Locally Important Wildlife Site	no	Ancient Woodland	No
Tree Preservation Order	No	Protected Local Green Space	no	Area of Great Landscape Value	no
Agri Land Class – More than 50% of site Grade 1, 2 or 3	no	Green Wedge	no	Scheduled Ancient Monument	No
Historic Park and Garden	No	Area of Outstanding Natural Beauty	no	Site specific minerals safeguarding area	Yes
Listed Building	Within 500m	Conservation Area	No		
Availability Check: When is the site available?			What use is the site promoted for?		
0 – 5 Years	Yes		Housing	Yes	
6 – 10 Years	No		Office	No	
11 – 15 Years	No		Industrial/ Warehouse	No	
16+ Years	No		Retail	No	
Achievability Check			Gypsy/ Traveller Site	No	
Viability assessment completed?	No		Mixed Use	No	
If yes, does it confirm site is viable?			Other Use	No	

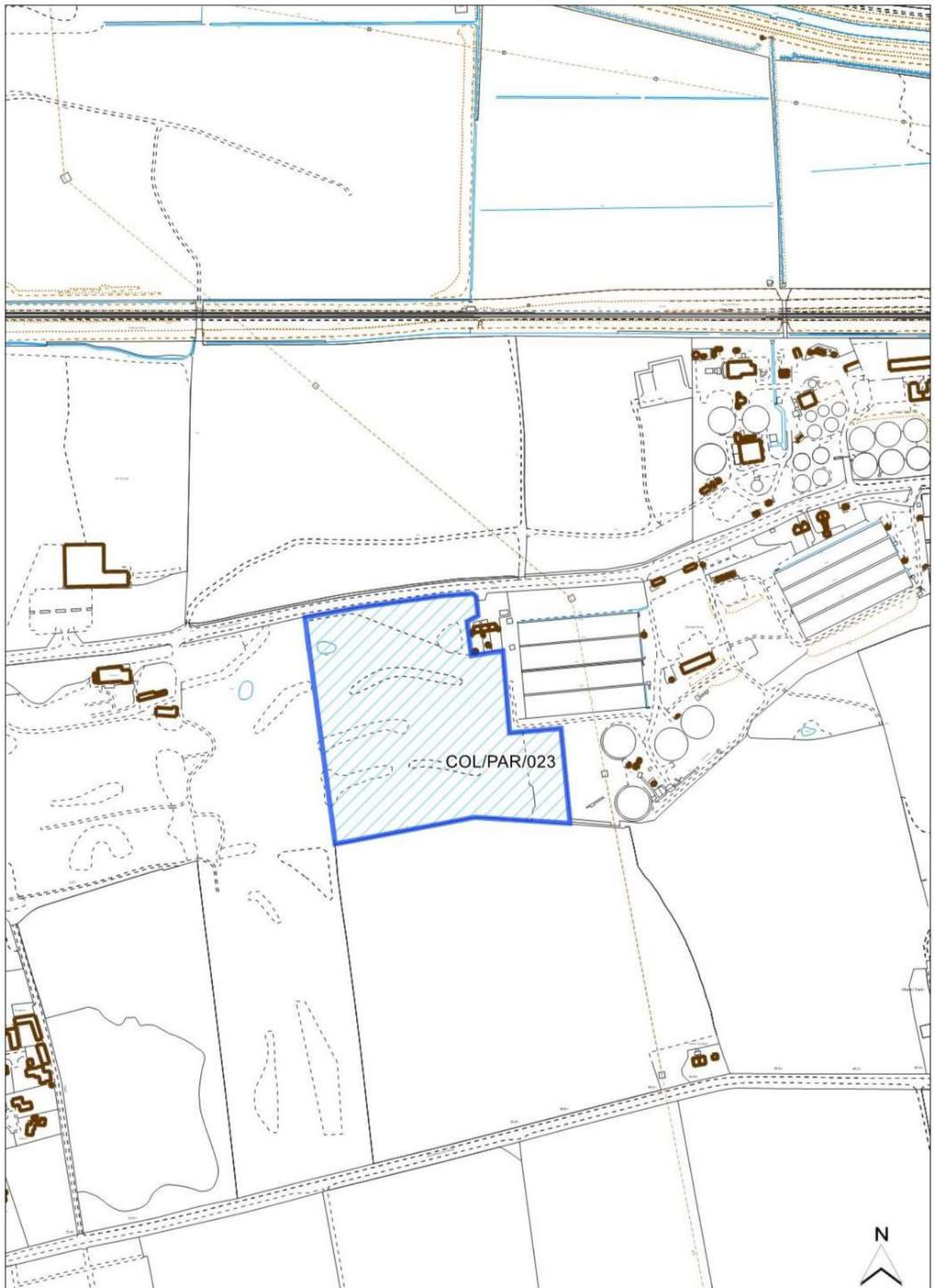

Site Reference	COL/PAR/023		
Old Reference (if applicable)			
Site Address	Former Canwick Golf Course		
Parish			
Ward	Park	Easting	
District	City of Lincoln	Northing	
Settlement Hierarchy	Countryside		
Current Use?	former golf course		
Brownfield/ Greenfield?	Greenfield		
Site Area (ha):	4.80	Potential Capacity: 144	

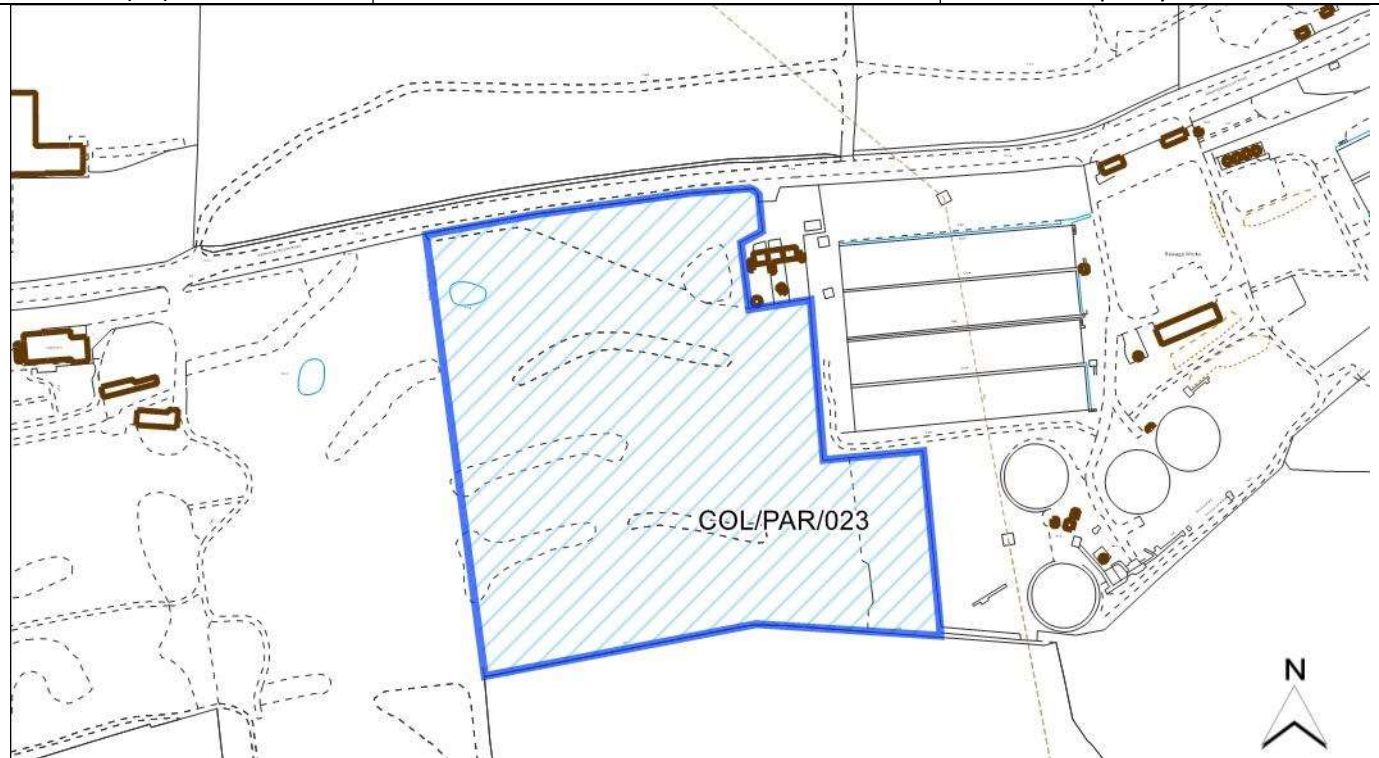

Constraint Check

Some or all of site in Flood Risk Zone 2	No	Surface Water Flooding – > 50% of site at High Risk	no	Within consultation zone of Hazardous Site or Pipeline	no
Nationally Important Wildlife Site	No	Locally Important Wildlife Site	Yes	Ancient Woodland	No
Tree Preservation Order	No	Protected Local Green Space	No	Area of Great Landscape Value	No
Agri Land Class – More than 50% of site Grade 1, 2 or 3	check	Green Wedge	yes	Scheduled Ancient Monument	No
Historic Park and Garden	No	Area of Outstanding Natural Beauty	No		
Listed Building	350m south-west	Conservation Area	No		

Availability Check: When is the site available?

What use is the site promoted for?

0 – 5 Years	Yes	Housing	Yes
6 – 10 Years	No	Office	Yes
11 – 15 Years	No	Industrial/ Warehouse	Yes
16+ Years	No	Retail	No
Achievability Check		Gypsy/ Traveller Site	No
Viability assessment completed?	No	Mixed Use	No
If yes, does it confirm site is viable?		Other Use	No

